

RENOGY ONE

Core

RSHGWSN-W02W-G1

VERSION A0



QUICK GUIDE

Before Getting Started

The quick guide provides important operation and maintenance instructions for Renogy ONE Core (hereinafter referred to as Core).

Read the quick guide carefully before operation and save it for future reference. Failure to observe the instructions or precautions in the quick guide can result in electrical shock, serious injury, or death, or can damage the Renogy ONE Core, potentially rendering it inoperable.

- Renogy ensures the accuracy, sufficiency, and the applicability of information in the quick guide at the time of printing due to continual product improvements that may occur.
- Renogy assumes no responsibility or liability for personal and property losses, whether directly and indirectly, caused by the user's failure to install and use the product in compliance with the quick guide.
- Renogy is not responsible or liable for failures, damages, or injuries resulting from repair attempted by unqualified personnel, improper installation and operation.
- The illustrations in the quick guide are for demonstration purposes only. Details may appear slightly different depending on product revision and market region.
- Renogy reserves the right to change the information in the quick guide without notice. For the latest quick guide, visit renogy.com.

Online Manual



Quick Guide



User Manual



What's In the Box?



RENogy ONE Core × 1



Quick Guide × 1

M3.5*14mm

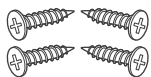

Mounting Screws × 4
(1 extra)

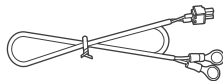

Power Cable (5m) × 1

Get to Know RENogy ONE Core

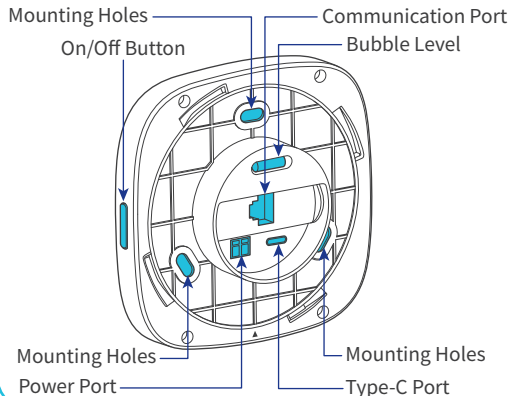

Installation Site and Environment

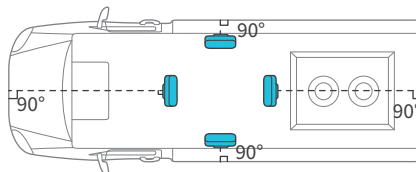

≤5000m



-4°F to 158°F
-20°C to 70°C



0% to 95%



i NOTE

- To enable the RV leveling function on Renogy ONE Core, ensure it is installed in a spot with the screen pointing to the front, rear, left, or right side of the RV, vertically to the RV floor. It is recommended that RV leveling blocks should be used during the leveling process.

Required Tools



Phillips Screwdriver (#1)

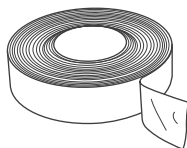

Insulation Tape

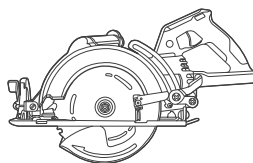

Skill Saw

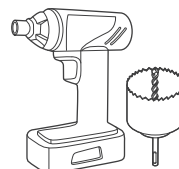

Impact Drill with
Hole Saw, 2.17in/55mm

i NOTE

- Tools are required only when the Core is flush mounted on a wall.
- You can use either a skill saw or an electric drill with hole saw.

Step 1 (A). Place Renogy ONE Core on a Table

The package box is environmentally friendly. You can use it as a bracket to hold the Core when installing it on the wall is not required.

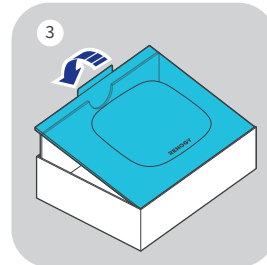
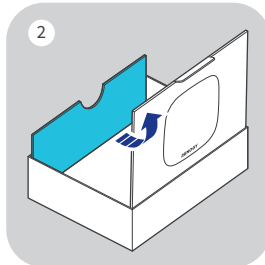
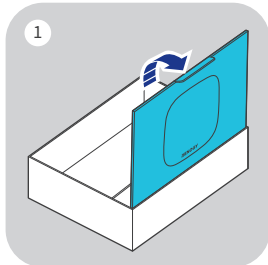

i NOTE

- The RV leveling function is unavailable on Core when it is placed on a table.



Mounting Template

Please tear off this piece of paper and paste it to the mounting location for drilling holes.

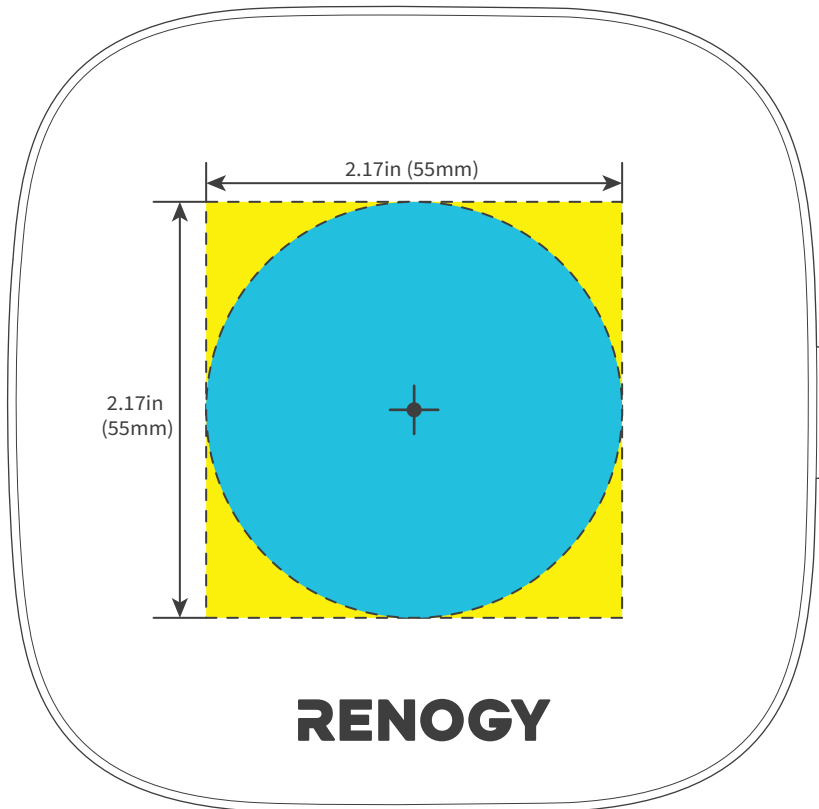

Step 1 (B). Mount Renogy ONE Core on a Wall

i NOTE

- You can also use another piece of paper as the mounting template. The installation hole comes in 2.17 in × 2.17 in (55 mm x 55 mm).

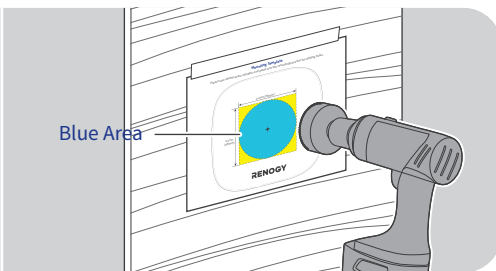
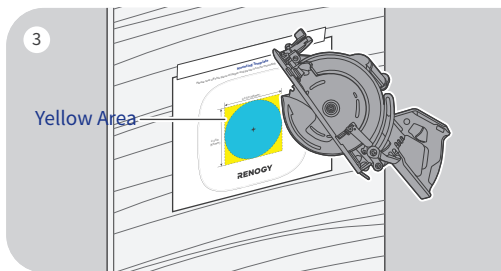
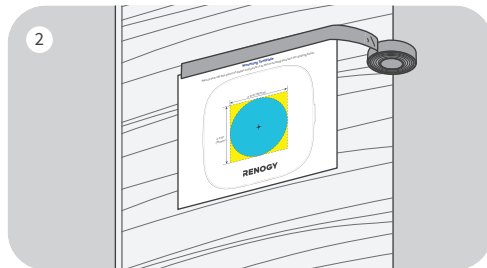
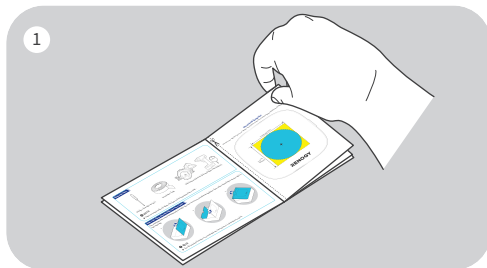

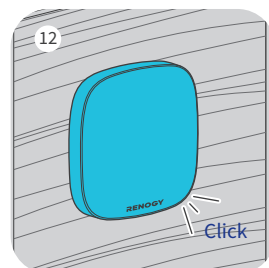
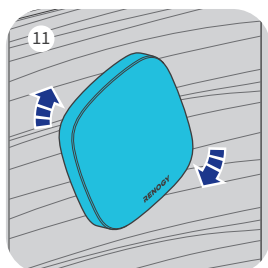
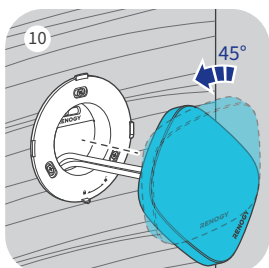
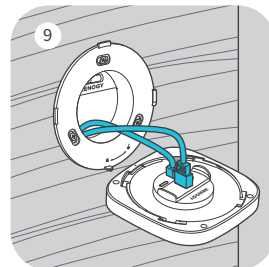
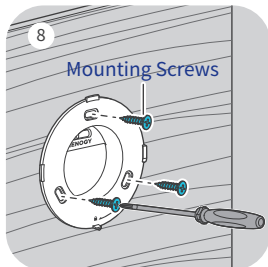
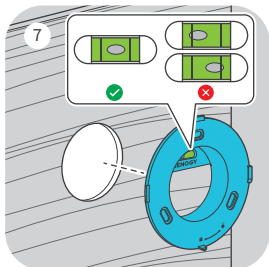
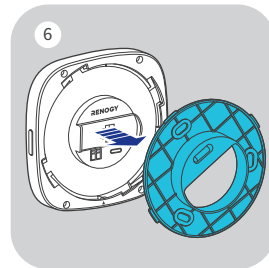
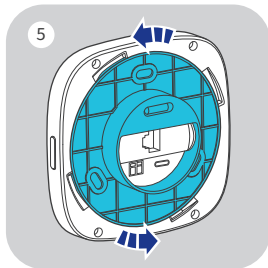
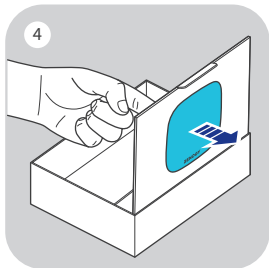

Step 2. Connect Renogy ONE Core to a Power Supply

You can connect Renogy ONE Core to a power supply through the included power cable or a Type-C cable (not included).

■ Installed on a Wall

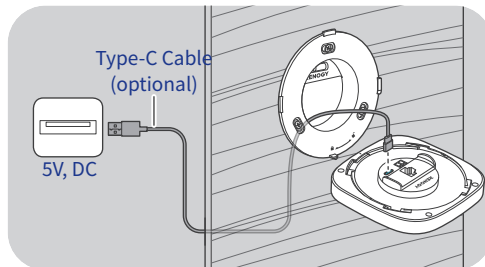
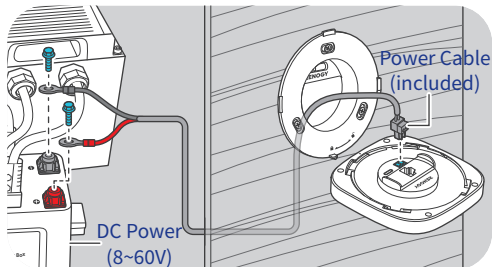

■ Installed on a Table

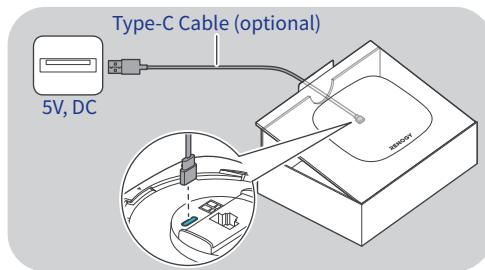
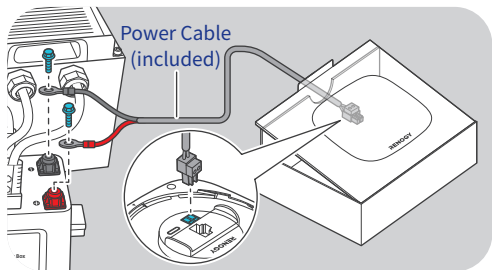

i NOTE

- When installing the power cable, always connect the negative first, and then the positive.

Step 3. Install a Communication Cable (Optional)

For details, see the Renogy ONE Core User Manual by scanning the QR code in the guide.

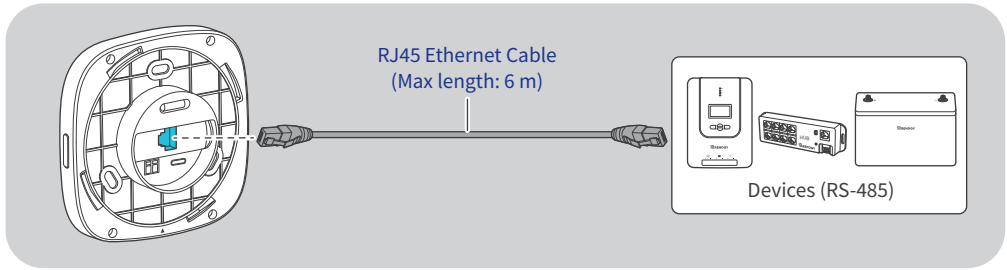

Step 4. Power On/Off

Long press the On/Off Button for 5s to power the Core on or off.

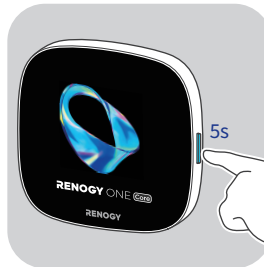

Step 5. Pairing with DC Home

For initial startup, follow the startup wizard on the Core to pair it with the DC Home app. Alternatively, go to **ⓘ > System > Pair with App**.

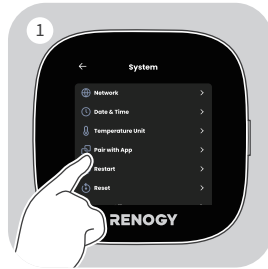

Step 6. Add Devices

Renogy ONE Core can connect to Bluetooth, Bluetooth mesh, and Zigbee Renogy devices concurrently.

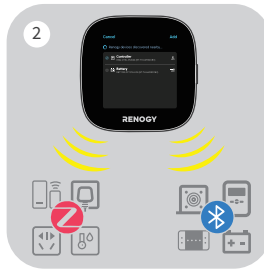
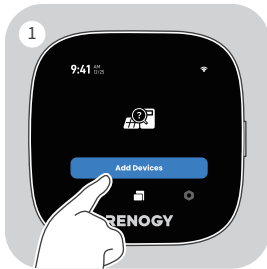

RV Leveling

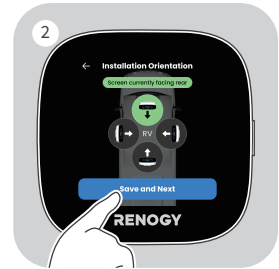

i NOTE

- RV leveling calibration on Renogy ONE Core is required each time the installation site for the Core is changed.

Important Safety Instructions

- Keep Renogy ONE Core out of the reach of children.
- Do not dispose of Renogy ONE Core as household waste. Comply with local, state, and federal laws and regulations and use recycling channels as required.
- Do not expose Renogy ONE Core to flammable or harsh chemicals or vapors.
- There are no serviceable parts in Renogy ONE Core. Do not open, dismantle, repair, tamper with, or modify it.
- Confirm the polarities of the devices before connecting Renogy ONE Core to a power supply. A reverse polarity contact can result in damage to the Core, thus voiding the warranty.
- Ensure that the connected DC power supply rates at 8V to 60V. Connecting the Core to a power source beyond the range results in a power-on failure or permanent damage to the Core.
- You can use an extended power cable on demand. For details, see Renogy ONE Core User Manual by scanning the QR code in the guide.

FCC Statement

This device complies with Part 15 of the FCC Rules. Operation is subject to the following two conditions:

- (1) This device may not cause harmful interference, and
- (2) This device must accept any interference received, including interference that may cause undesired operation.

Warning: Changes or modifications not expressly approved by the party responsible for compliance could void the user's authority to operate the equipment.

This equipment has been tested and found to comply with the limits for a Class B digital device, pursuant to Part 15 of the FCC Rules. These limits are designed to provide reasonable protection against harmful interference in a residential installation. This equipment generates uses and can radiate radio frequency energy and, if not installed and used in accordance with the instructions, may cause harmful interference to radio communications. However, there is no guarantee that interference will not occur in a particular installation. If this equipment does cause harmful interference to radio or television reception, which can be determined by turning the equipment off and on, the user is encouraged to try to correct the interference by one or more of the following measures:

- (1) Reorient or relocate the receiving antenna.
- (2) Increase the separation between the equipment and receiver.
- (3) Connect the equipment into an outlet on a circuit different from that to which the receiver is connected.
- (4) Consult the dealer or an experienced radio/TV technician for help.

FCC Radiation Exposure Statement

This equipment complies with FCC radiation exposure limits set forth for an uncontrolled environment. This equipment should be installed and operated with minimum distance 20cm between the radiator & your body.

RSS Standard

This device complies with Industry Canada license exempt RSS standard(s). Operation is subject to the following two conditions:

- (1) This device may not cause interference, and
- (2) This device must accept any interference, including interference that may cause undesired operation of the device.

The device is compliance with RF exposure guidelines, users can obtain Canadian information on RF exposure and compliance. The minimum distance from body to use the device is 20cm.

Renogy Support

To discuss inaccuracies or omissions in this quick guide or user manual, visit or contact us at:

 | renogy.com/support/downloads



→ contentservice@renogy.com

For technical questions about your product in the U.S., contact the Renogy technical support team through:

 | renogy.com/contact-us



1(909)2877111

For technical support outside the U.S., visit the local website below:

Canada |  | ca.renogy.com

China |  | www.renogy.cn

United Kingdom |  | uk.renogy.com

Japan |  | renogy.jp

Australia |  | au.renogy.com

Germany |  | de.renogy.com

South Korea |  | kr.renogy.com

Other Europe |  | eu.renogy.com

Disclaimer

Renogy ONE Core Quick Guide © 2023 Renogy. All rights reserved.

RENOGY and **RENOGY** are registered trademarks of Renogy.

- All information in the quick guide is subject to copyright and other intellectual property rights of Renogy and its licensors. The quick guide may not be modified, reproduced, or copied, in whole or in part, without the prior written permissions of Renogy and its licensors.
- The registered trademarks in the quick guide are the property of Renogy. The unauthorized use of the trademarks is strictly prohibited.

Renogy Empowered

Renogy aims to empower people around the world through education and distribution of DIY-friendly renewable energy solutions.

We intend to be a driving force for sustainable living and energy independence.

In support of this effort, our range of solar products makes it possible for you to minimize your carbon footprint by reducing the need for grid power.

Live Sustainably with Renogy

Did you know? In a given month, a 1kW solar energy system will...



Save 170 pounds of coal from being burned



Save 300 pounds of CO₂ from being released into the atmosphere



Save 105 gallons of water from being consumed

Renogy Power PLUS

Renogy Power Plus allows you to stay in the loop with upcoming solar energy innovations, share your experiences with your solar energy journey, and connect with like-minded people who are changing the world in the Renogy Power Plus community.



@Renogy Solar



@renogyofficial



@Renogy

Renogy reserves the right to change the contents of this manual without notice.

Manufacturer: RENOGY New Energy Co.,Ltd
Address: No.66, East Ningbo Road Room 624-625
Talcang German Overseas Students Pioneer Park
JiangSu 215000 CN

Manufacturer: RENOGY New Energy Co.,Ltd
Address: No.66, East Ningbo Road Room 624-625
Talcang German Overseas Students Pioneer Park
JiangSu 215000 CN

EC REP

eVatmaster Consulting GmbH
Battinistr. 30
60325 Frankfurt am Main, Germany
contact@evatmaster.com

UK REP

EVATOST CONSULTING LTD
Suite 11, First Floor, Moy Road Business
Centre, Taffs Well, Cardiff, Wales, CF15 7QR
contact@evatmaster.com



FCC ID: 2ANPBGWSN-W02W
IC: 23590-RSHGWSNW02W

 **RENOGY**